

# Zilla® Double Stud Flashing Assembly Instructions

Use the following instructions to install the Zilla® Double Stud Flashing (patent pending).

## Parts included in the assembly:

- Zilla® Base Plate
- Zilla® Flashing
- Zilla® Double Stud
- High Temperature Washer

## Parts & Tools needed (in addition to the assembly):

- Appropriate fastening hardware for approved method of attachment in accordance with shingle manufacturer, project design and AHJ (Authority Having Jurisdiction)
- Caulk and Caulk gun (optional)
- Miscellaneous tools as required

## Installation Steps

### Step 1 - Attach the Base Plate

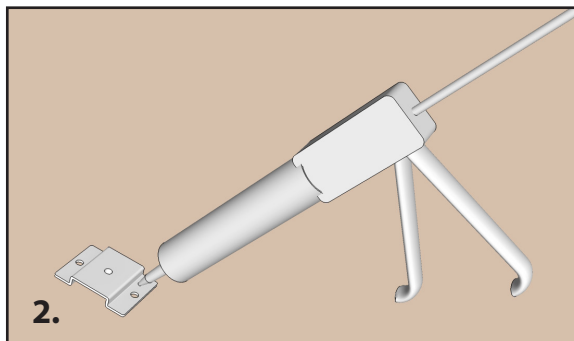
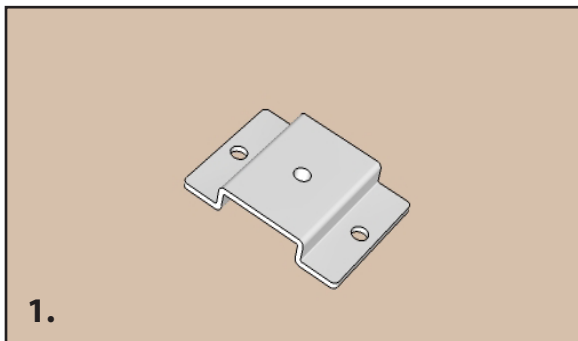

1: Locate and mark your Base Plate location. Make sure to orientate the Base Plate so both holes will attach to the structural member(s).

2. Option: squeeze a bead of caulk in both mounting holes before inserting fasteners for added protection.

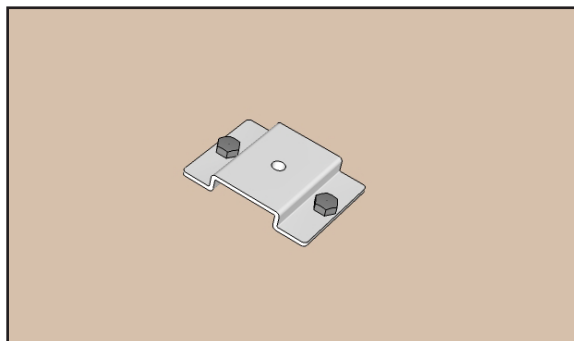
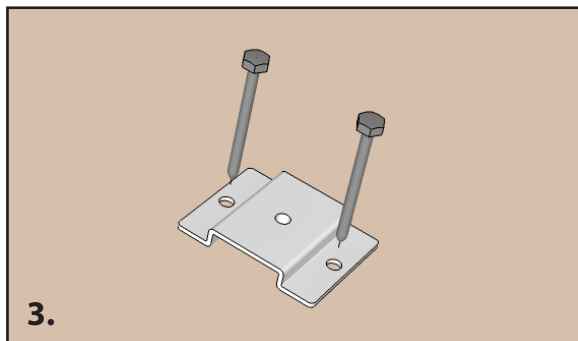

3: Attach the Base Plate to the structural member through the mounting holes with appropriate fasteners for your project; and in accordance with AHJ (Authority Having Jurisdiction). Be careful not to over tighten fasteners used to attach Base Plate.

### Step 2 - Attach the flashing

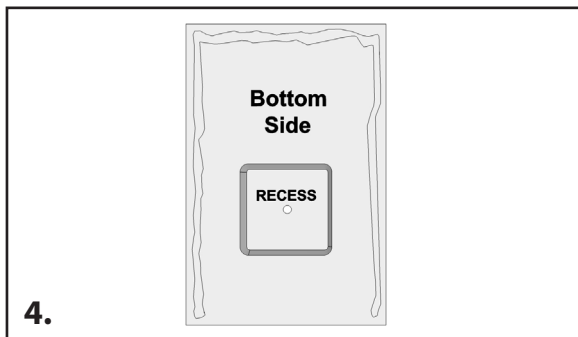

4. Option: install a bead of caulk on the top and sides of the underside of the Flashing prior to installing. IMPORTANT- do not caulk bottom underside of Flashing.

Patent(s) Pending

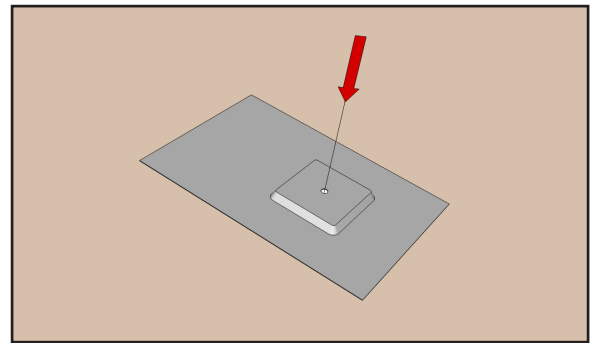
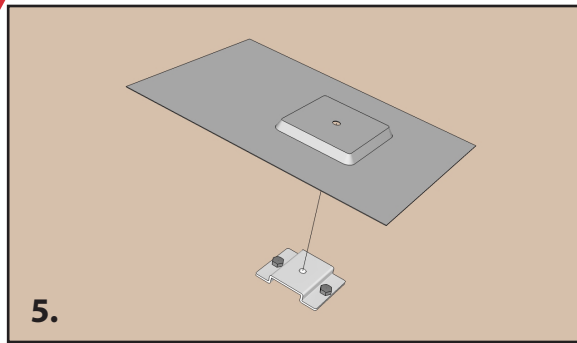

5. Install the Flashing in accordance with the shingle manufacturer recommendations and with AHJ requirements for exposure and proper coverage. Carefully install the Flashing under the shingle course above with the required coverage and align the center hole over the threaded hole in the base plate.

### Step 3 - Attach the Double Stud

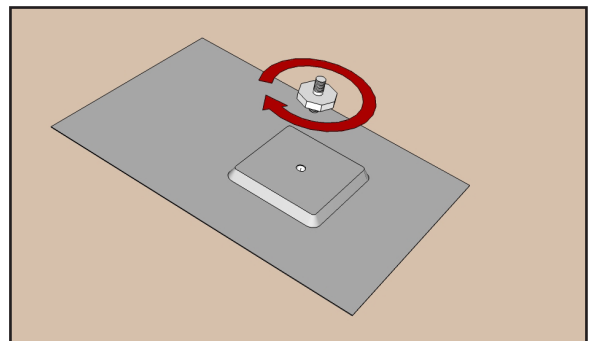
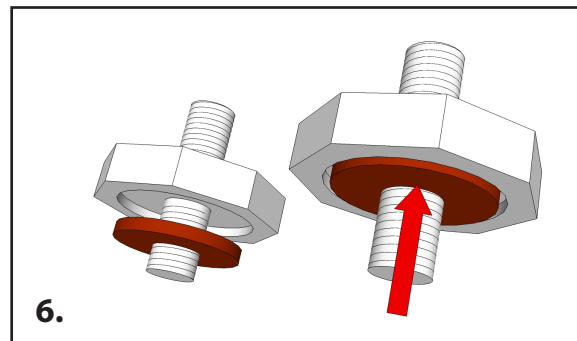

6. Thread the Double Stud with the washer side down (recess down) into the hole sandwiching the flashing between the top of the base plate and Double Stud (washer). Turn Double Stud (by hand) until flashing is compressed between top of base plate and washer. NOTE: Once Flashing is in contact with Base Plate and washer, turn Double Stud 1/8 to 1/4 turn to tighten. DO NOT OVER TIGHTEN Double Stud.

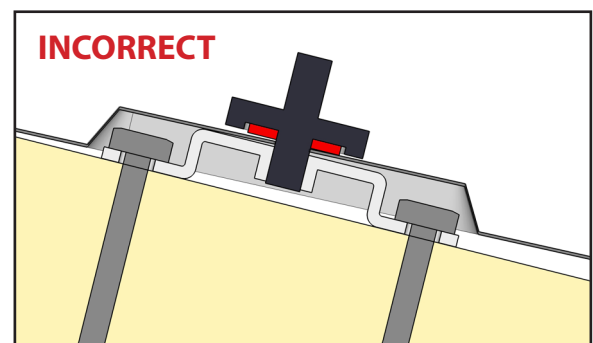
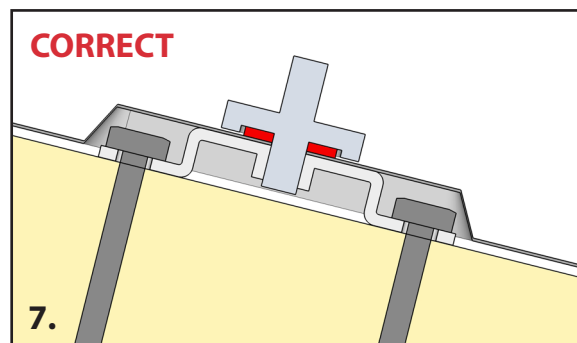

7. Visually inspect the connection and verify the washer is properly seated and the reveal around the washer is even.

Congratulations: the Zilla® Double Stud Flashing Assembly is now complete - So Simple It's Scary!



855.670.1212 | [zillarc.com](http://zillarc.com)

Patent(s) Pending

Disclaimer: The installer is fully responsible for getting the system verified and approved for all local and state building codes and all Authorities Having Jurisdiction (AHJ). Zilla Corporation assumes no liability whether assumed or implied.